

Electrical Characteristics					
Parameters	Sym	Min	Typ	Max	Unit
Supply Voltage	V_{DC}	8	12	15	V
Supply Current	I_{DC}	-	3.5	4.2	A

Other Specification	
Working Temperature	-20 °C / +85 °C
Weight (g)	270 g
Box	Aluminum
Connection Pins	Set Screw / M5

Wiring Diagram	
Pin (+)	+ 12 V DC
Pin (-)	- 12 V DC
Igniter Pin	Spark Plug
Igniter Pin	Ground

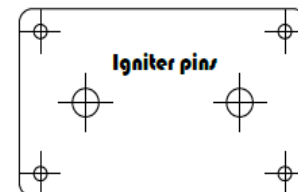
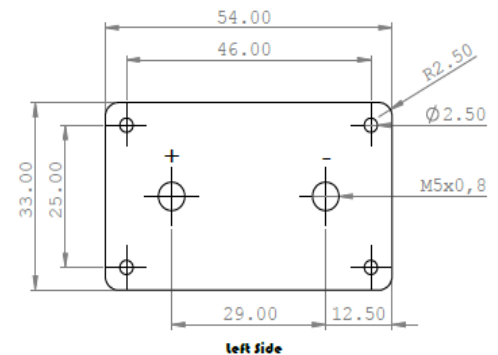
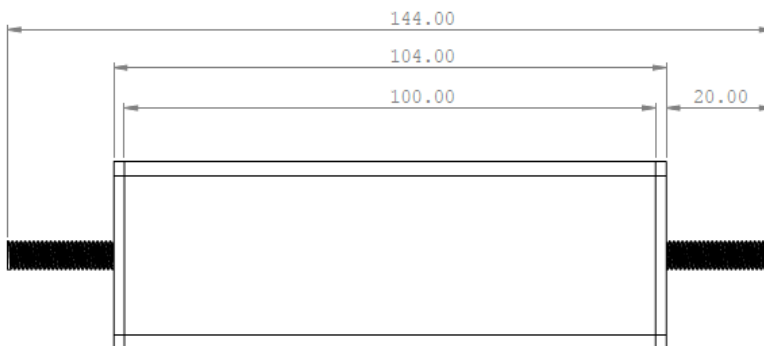

Right side

Warning!

*Don't use without spark plug.

*Don't touch surface when working igniter.

*Continuous working time is 45 seconds in one shot ignition. Please, allow a cooling time of 15 seconds for every 45 seconds of operation.